

5.7mm BGA

000

| | |
|--------|------------------------|
| 0 | ENG 00 |
| 00 0 | 5.7mm BGA SF038B570B33 |
| 00 | 00 |
| 0 | 0B |
| 00 | SWP |
| 00 | 0 0 00 0 |
| 00 0 | 35 ±20 |
| 00 000 | 50m 00 |
| 000 | 1.100 |
| 000 | 100 00 00 0 00 |
| 0 00 | 2-15 0 00 0 00 |

00 000



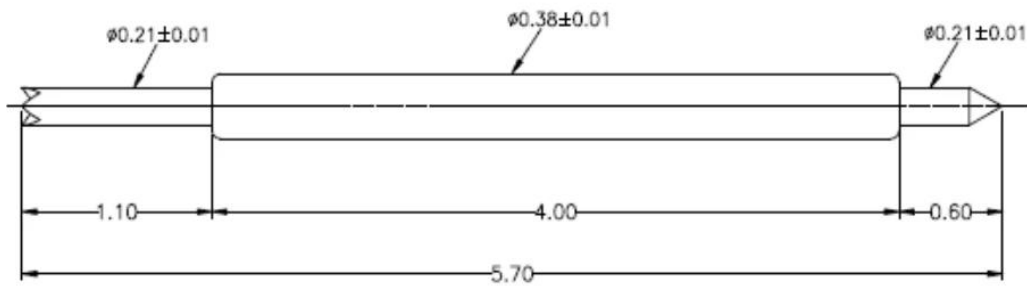



□□□□□□

1. we have 30 years experience in probe pin and have ourself factory.
2. we provide free sample and have a testing department.
3. we could manufacture products as your request.
4. we guarantee best price and good service.

□□□□□□□□

Spring loaded pin (single) for PCB, ICT, FCT testing etc;
Pogo pin (connector) to establish connection between two printed circuit boards for charging, locating, Battery, Semiconductor & Interconnect applications;
Double ended probe for BGA and Semiconductor testing;
Universal pin without spring, coating pin, LM pin with QZ and VZ series;
High current probe, Switch probe, Capacitance needle;
Terminal & receptacle /socket;
Other related electronic components, 30# OK wire, Jig locks, POM, Iron hinge etc

□□□□

| | | |
|------------------------------------------------------------------------------------|------------------------------------------------------------------------------------|-------------------------------------------------------------------------------------|
| Spring exhausted tester | DC power supply | Current resistance tester |
|  |  |  |
| Microscope | Tensile strength tester | Spring tester |
|  |  |  |

□□

