

5.7mmBGA

|  |                       |
|--|-----------------------|
|  | ENG                   |
|  | 5.7mmBGA SF038B570B33 |
|  |                       |
|  | B                     |
|  | SWP                   |
|  |                       |
|  | 35 ±20                |
|  | 50m                   |
|  | 1.1                   |
|  | 100                   |
|  | 2-15                  |

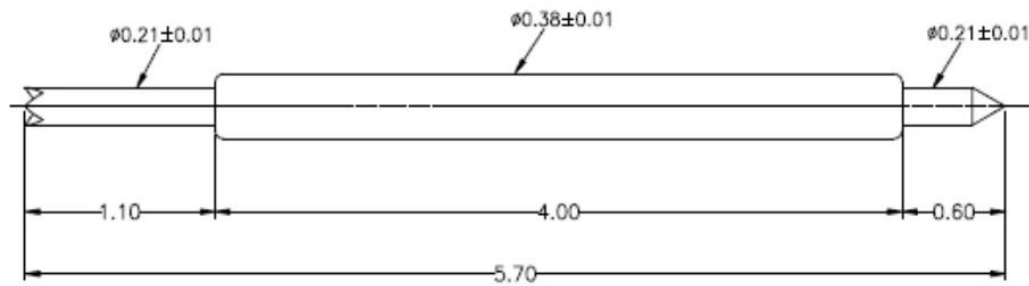









□□□□□□

1. we have 30 years experience in probe pin and have ourself factory.
2. we provide free sample and have a testing department.
3. we could manufacture products as your request.
4. we guarantee best price and good service.

□□□□□□□□

Spring loaded pin (single) for PCB, ICT, FCT testing etc;  
Pogo pin (connector) to establish connection between two printed circuit boards for charging, locating, Battery, Semiconductor & Interconnect applications;  
Double ended probe for BGA and Semiconductor testing;  
Universal pin without spring, coating pin, LM pin with QZ and VZ series;  
High current probe, Switch probe, Capacitance needle;  
Terminal & receptacle /socket;  
Other related electronic components, 30# OK wire, Jig locks, POM, Iron hinge etc

□□□□□

|  |  |   |
|--|--|---|
| Spring exhausted tester  | DC power supply  | Current resistance tester   |
|   |   |   |
| Microscope   | Tensile strength tester  | Spring tester   |
|  |  |  |

