

□□□□

□□	□□
□□□□	SF-PPA2.0X10.1-D
□□	□□□□□
□	□□□□□
□□□	150A
□□□□□	100□
□□□□	□□□□□7□□□□

□□□

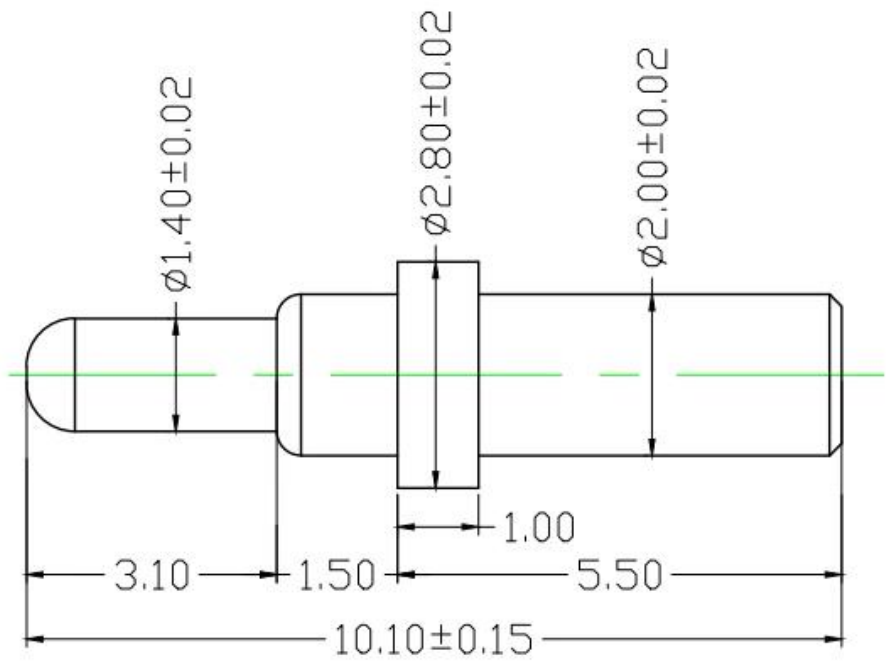

□□□□



產品介紹

1. 產品規格 24 個裝
2. 產品規格表
3. 產品規格表
4. 產品規格表

產品特點

● PCB/ICT/FCT 測試

Pogo pin 測試

● BGA 測試







QZ/VZ 測試

● 產品規格

● 產品規格

● 產品規格 30#OK 產品規格 POM 產品規格

□□□□

Spring exhausted tester	DC power supply	Current resistance tester
 A tall, white, cabinet-style machine with a glass door on the upper half and a control panel on the right side.	 A white, rectangular device with a black front panel. It features a red emergency stop button, a red power switch, and several control knobs and dials. The brand name 'YoRi' is visible on the top left.	 A white, rectangular device with a large green digital display showing '8888'. It has a control knob and a warning symbol on the right side.
Microscope	Tensile strength tester	Spring tester
 A white and black compound microscope with a stage, objective lenses, and an eyepiece.	 A blue and white machine with a vertical column and a horizontal arm, used for testing the tensile strength of materials.	 A white machine with a vertical column and a horizontal arm, used for testing the properties of springs.

□□□□

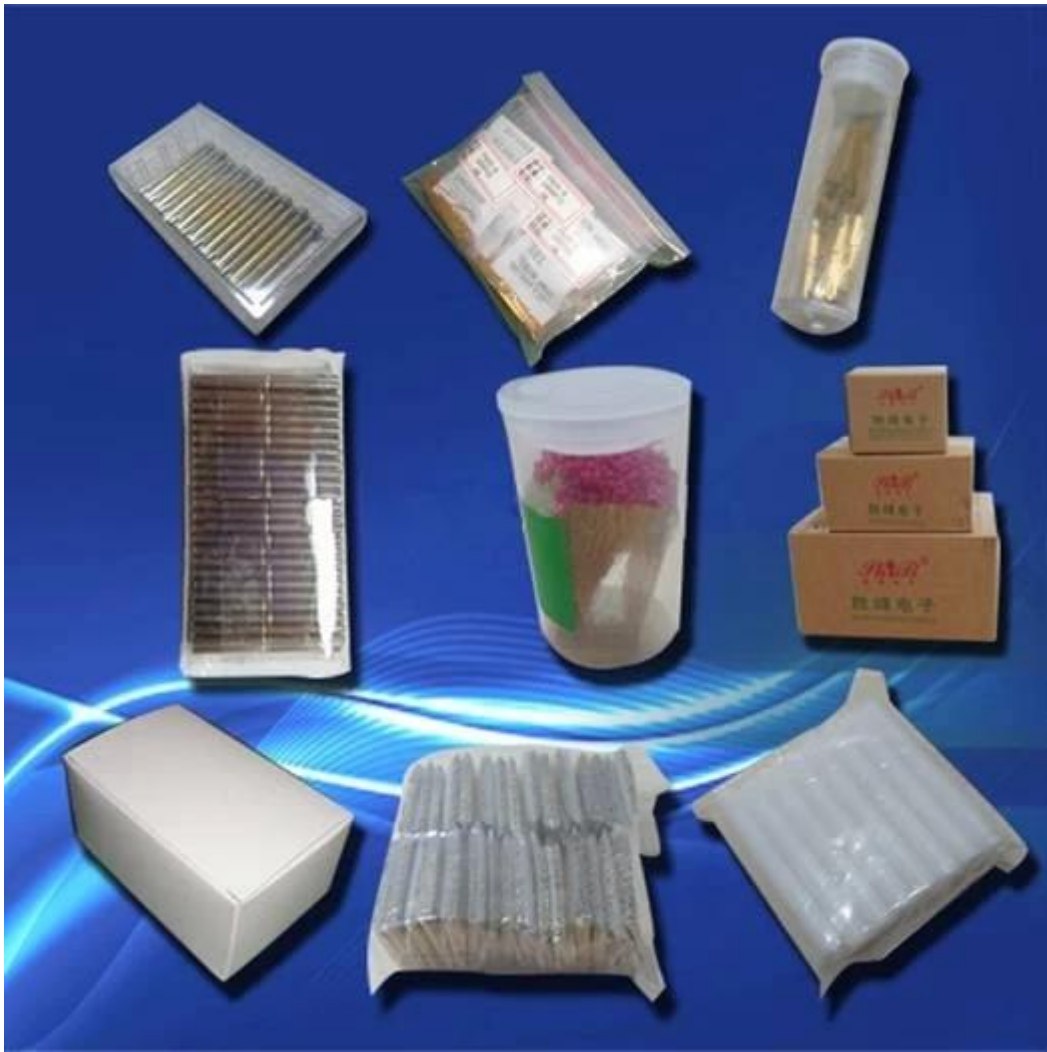

□□□□

