

□□□□

□□ □□	□ □ □□ □ SF-PPA0.58 *8.85 □□
□□	□□□ □ □
□□	SWP □ □ □
□□ □□	2A
□□ □	20±7GF @ □□□ □□ 0.80 □□
□ □□	□ 2 □□□ □ □ □□ □ □□

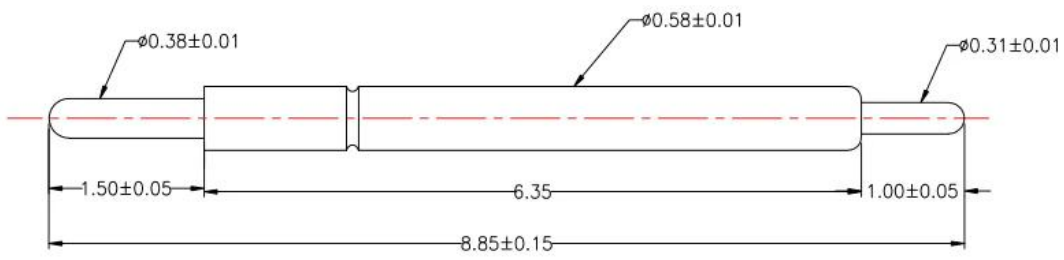



產品

1. 24pin 連接器
 2. OEM
 3. 各種規格
- 產品

應用

PCB ICT FCT;

Pogo pin;

BGA;







□□□□□□□□□□□□□□□□QZ□VZ□□□LM□;

□□□□□□□□□□□□□;

□□&□□/□□;

□□□□□□□□30□OK□□□□□□□□POM□□□□□□

□□□□

Spring exhausted tester	DC power supply	Current resistance tester
		
Microscope	Tensile strength tester	Spring tester
		

□□□□

