

[Pin de doble extremo de 5,7 mm de longitud para BGA](#)

Especificación:

Marca	SFENG INVESTIGACION
Artículo Número	Pin de doble extremo de 5,7 mm de longitud para BGA SF038B570B33
Émbolo	Becu
Barril	PhBz
Primavera	SWP
Enchapado	oro chapado terminado níquel
Primavera fuerza	35g \pm 20%
Contacto Resistencia	\square 50m ohm
Carrera completa	1.1mm
MOQ	100 piezas Si nosotros tener valores
Dirigir hora	2-15days después recepción la pago

Imagen Mostrar:



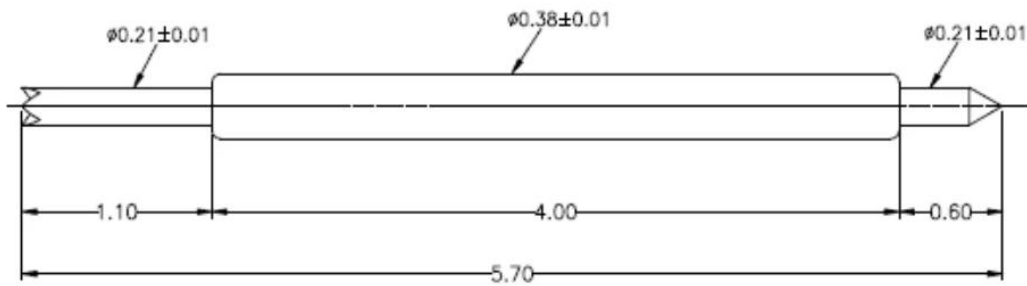







Nuestras ventajas:

1. we have 30 years experience in probe pin and have ourself factory.
2. we provide free sample and have a testing department.
3. we could manufacture products as your request.
4. we guarantee best price and good service.

Nuestro producto principal:

Spring loaded pin (single) for PCB, ICT, FCT testing etc;
Pogo pin (connector) to establish connection between two printed circuit boards for charging, locating, Battery, Semiconductor & Interconnect applications;
Double ended probe for BGA and Semiconductor testing;
Universal pin without spring, coating pin, LM pin with QZ and VZ series;
High current probe, Switch probe, Capacitance needle;
Terminal & receptacle /socket;
Other related electronic components, 30# OK wire, Jig locks, POM, Iron hinge etc

Equipo de pruebas:

Spring exhausted tester	DC power supply	Current resistance tester
		
Microscope	Tensile strength tester	Spring tester
		

Paquete:

