

Product Picture

Product Name	Double head pogo pin SF-PPA0.58*8.85mm
Material	Bronze, gold plated
Spring	SWP, gold plated
Current ration	2A
Spring force	20±7gf @ working stroke 0.80mm
Lead time	within 2 working days after receiving the payment

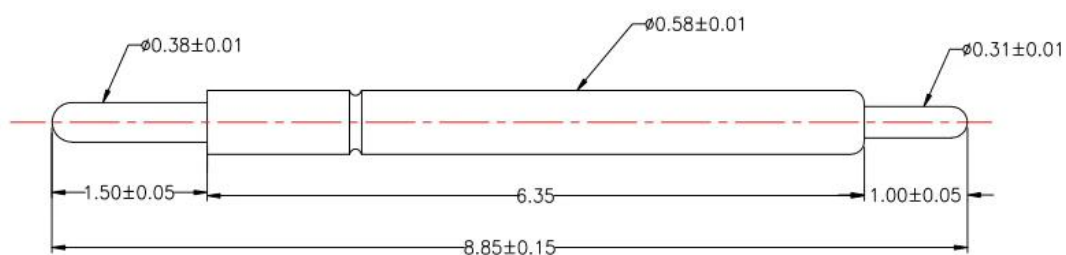



Our Service

1. We can reply your inquiry within 24 working hours.
2. Customized design is available and OEM are welcomed.
3. We can deliver the probe pins to our clients all over the world with speed and precision.
4. We can provide the lowest price with high quality product to our client .

Main Products

Spring loaded pin (single) for PCB, ICT, FCT testing etc;

Pogo pin (connector) to establish connection between two printed circuit boards for charging, locating, Battery, Semiconductor & Interconnect applications;

Double ended probe for BGA and Semiconductor testing;

Universal pin without spring, coating pin, LM pin with QZ and VZ series;

High current probe, Switch probe, Capacitance needle;

Terminal & receptacle /socket;

Other related electronic components, 30# OK wire, Jig locks, POM, Iron hinge etc

Quality Control

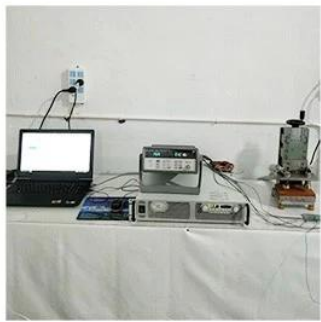

1. Agilent current testing

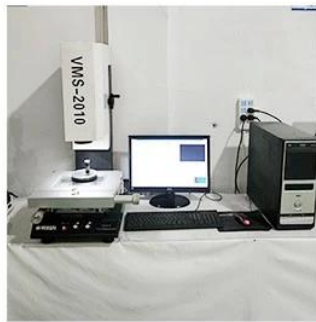

2. Quadratic element

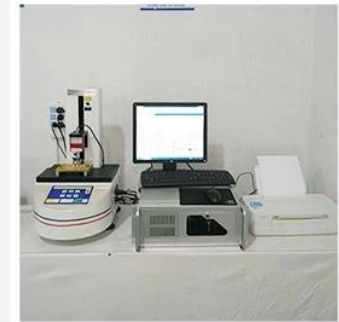

3. Load Curve Meter



4. Bond Test



5. Life Fatigue Test



6. Microscope

Packing Picture



shipping information

Standard products will be delivered out within 3 days. Customized products will be sent out within 15 days.

