

□□□□

□□ □□ □ □□□□ □□□□ □ □□ □□□□□ □□□ □□□ □□ □□ □□ □ □□□ □□□□ □□ □□□ □□ □ □□ □□□□ □ □□□□□ □ □□□□□

□□□□

□□□□	SF5904
□□□□□□□	1.5mm
□□□□□□□	1.0mm
□□□	100±20%gf@ □□ 2.0mm
MOQ	200□
□□□□□□	□□□□□□□□□□□□
□□□	T/T
□□	□□□□□□□□□□ 5 □ 10 □

□□ □□□□□

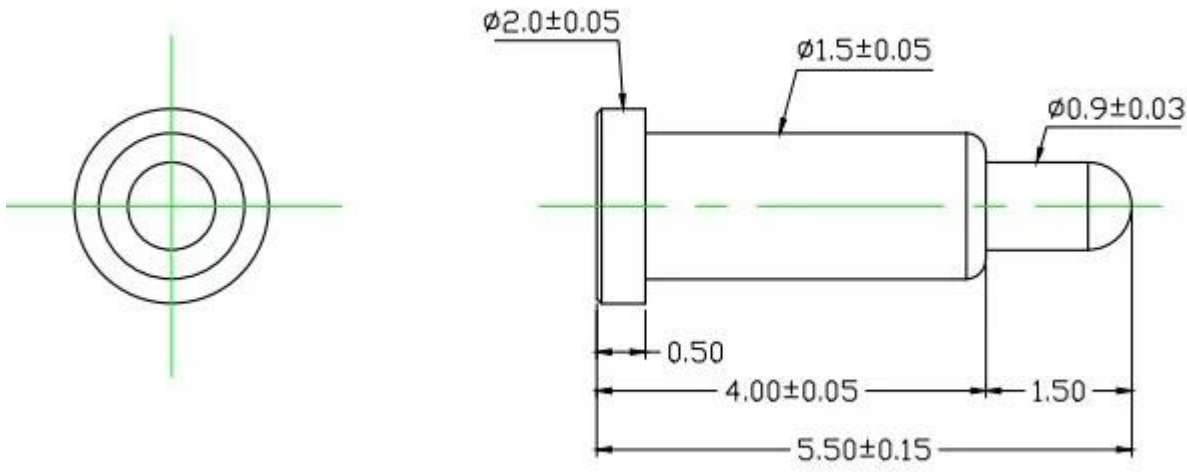

□□ □□



1. raw material warehouse



2. Lathe workshop



3. Assemble workshop



4. Quality inspection



5. Finished products



6. Packing



Measuring Equipment >

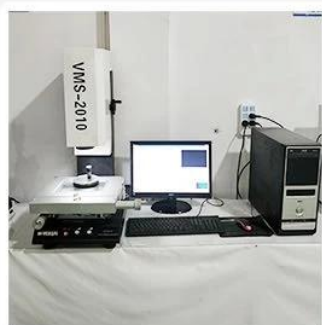

Measuring Equipment:

1. Agilent current testing;
2. Quadratic element measurement
3. Load Curve Meter
4. Bond Test
5. Life Fatigue Test



