

□□□□

□□□□	SF3151
□□□RM□□	35A
□□□□	50mΩ
□□□	900±100gf□□□ 6.0mm
□□□□□□	□□□□□□□□□□□□
□□	□□□□□□□□□□
□	SUS
□□□□□□□□□□	OEM □ ODM
MOQ	100□
□□□□□	□□□□□□□□□□□□
□□□	100% T/T□□□
□□	□□□□□□□□□□ 5 □ 10 □

□□ □□□□□

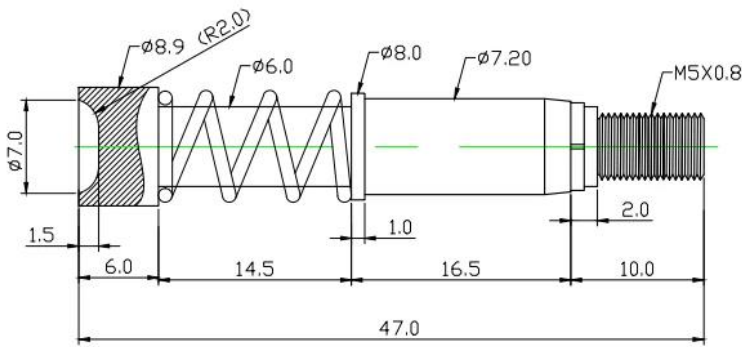

名称: SF-35A大电流针φ7.2X47

Materials(Plated) (材質與鍍層):
 Barrel(針套) : Brass(黃銅) , Ni
 Plunger(針軸) : Brass(黃銅) , Au on Ni Plated
 Spring(彈弓) : SUS (不銹鋼線) , /

Specifications (技術要求):
 Current Rating(額定電流) : 35A
 Contact Resistance(接觸電阻) : 50mΩ
 Rated Stroke(額定沖程) : 6.00mm
 Spring Force(額定彈力) : 900g±100gf@ load 6.00mm

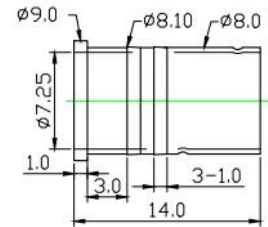

名称: SF-BR-35A大电流针φ7.2X47

材质: Brass(黃銅) Ni

□□ □□



1. raw material warehouse



2. Lathe workshop



3. Assemble workshop



4. Quality inspection



5. Finished products



6. Packing



Measuring Equipment >



Measuring Equipment:

1. Agilent current testing;
2. Quadratic element measurement
3. Load Curve Meter
4. Bond Test
5. Life Fatigue Test



