

## Product Description

A coaxial probe is used in microwave engineering and RF testing to measure the electrical properties of materials, such as dielectric constant, loss tangent, and conductivity. It is also used to characterize the performance of microwave components, such as filters, amplifiers, and antennas. The probe consists of a coaxial cable with a small, exposed conductor at the end that is inserted into the material being tested. The electrical properties of the material are determined by measuring the reflection and transmission of microwave signals through the probe.

## Product drawing:

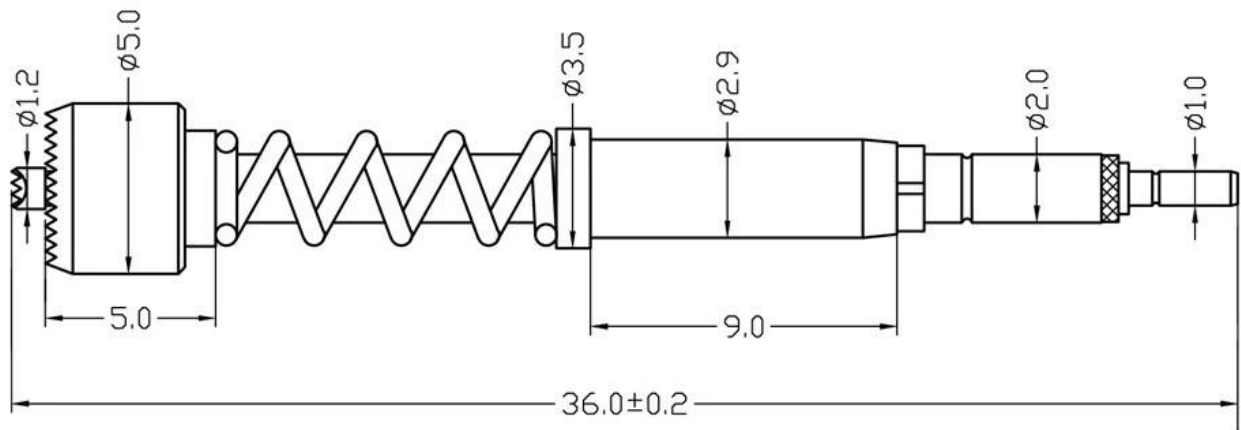

## Product Parameters:

Model:	SF-2.9X36-5.0
Material:	Copper Alloy
Current Rating:	5A
Contact Resistance (Initial)	$\leq 5\text{m}\Omega$
Maximum Travel	$\geq 4.5\text{mm}$
Recommended Working Travel	$580\text{g} \pm 20\%(2.5\text{mm})$

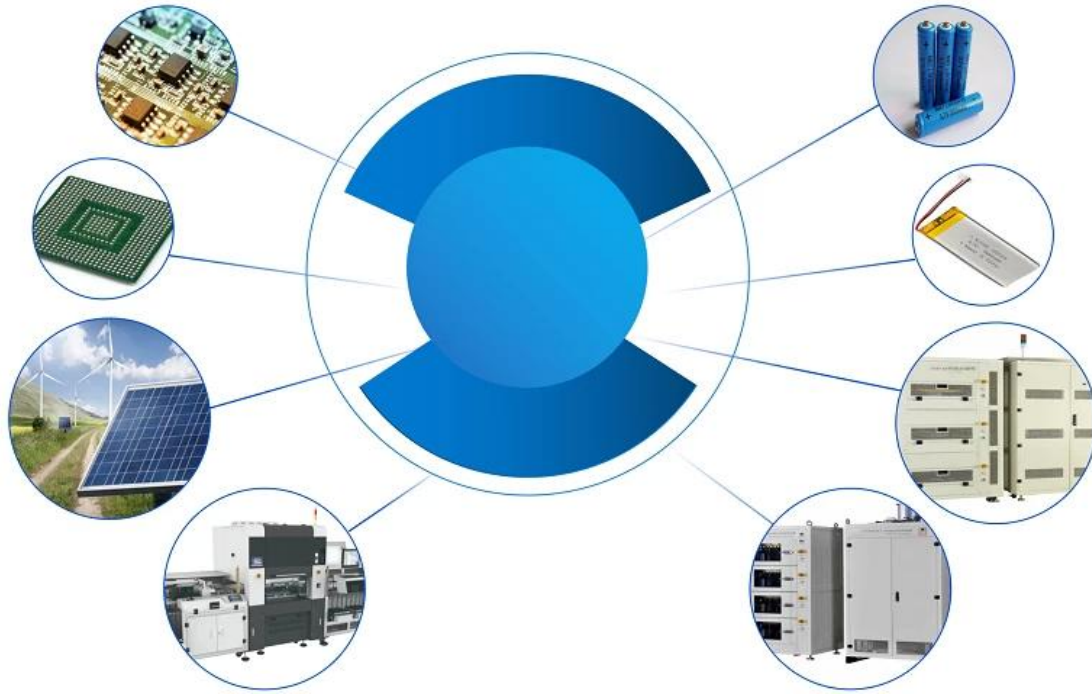

**Package:**



## Logistics:

Sample order ship by DHL, UPS, FedEx, TNT, EMS etc

For mass order delivery, can be optional with terms of Exwork, FOB, CNF, CIF by air or by sea based on the buyer's forwarder or ours



**Factory Show:**









