

Product specifications

Item number	SF3151
Current Rating	35A
Contact Resistance	50mΩ
Spring force	900±100gf@load 6.0mm
Plunger	Brass,Au on Ni plated
Barrel	Brass,Ni plated
Spring	SUS
Customize support	OEM & ODM
MOQ	100PCS
Package	Plastic bag, carton box
Payment	100% T/T before shipment
Delivery time	5-10days after receiving the payment

Product Pictures

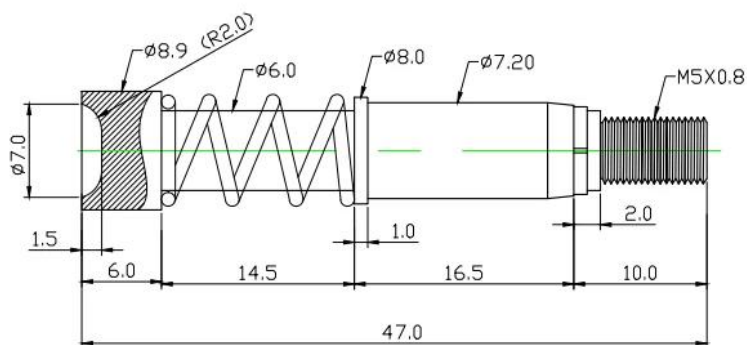

名称: SF-35A大电流针ø7.2X47

Materials(Plated) (材質與鍍層):
 Barrel(針套) : Brass(黃銅) , Ni
 Plunger(針軸) : Brass(黃銅) , Au on Ni Plated
 Spring(彈弓) : SUS (不銹鋼線) , /

Specifications (技術要求):
 Current Rating(額定電流) : 35A
 Contact Resistance(接觸電阻) : 50mΩ
 Rated Stroke(額定沖程) : 6.00mm
 Spring Force(額定彈力) : 900g±100gf@ load 6.00mm

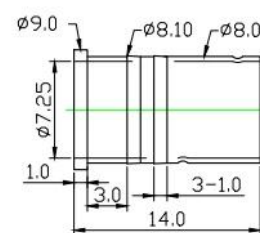

名称: SF-BR-35A大电流针ø7.2X47

材质: Brass(黃銅) Ni

Production Flow



1. raw material warehouse



2. Lathe workshop



3. Assemble workshop



4. Quality inspection



5. Finished products



6. Packing

Testing Equipment

Measuring Equipment >

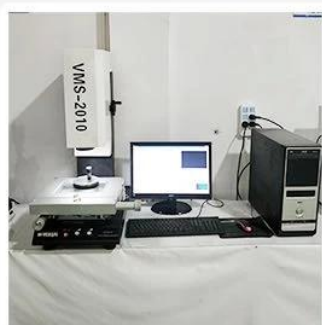

Measuring Equipment:

1. Agilent current testing;
2. Quadratic element measurement
3. Load Curve Meter
4. Bond Test
5. Life Fatigue Test

Packing



Main products

- 1.Spring loaded pin(single)for PCB,ICT,FCTtesting etc;
- 2.Pogo pin(connector)to establish connection between two printed circuit boards for charging,locating,battery,semiconductor&interconnector applications;
- 3.Double ended probes for BGA and semiconductor testing;
- 4.Universal pin without spring,coating pin,LM pin with QZ and VZ series;
- 5.High current probe,switch probe,capacitance needle;
- 6.Terminal&receptacle/socket;
- 7.Other related electronic components,Jig locks,POM and etc.

Whatever you want,please contact us without hesitation ,and we will try our best to meet your requirement within our capability.

Our service

- 1.We can reply your inquiry within 24 working hours;
- 2.Customized design is available and OEM are welcomed;
- 3.We can deliver the probe pins to our clients all over the world with speed and precision.
- 4.We can provide the lowest price with high quality products to our clients.